

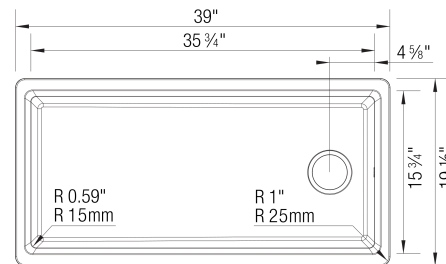

Sink Specifications

Colour	SKU
Café	403897
Coal Black	403892
Truffle	403896
White	403895
Anthracite	403893
Cinder	403894
Soft White	403899
Volcano Gray	403898

INTEOS 39 SILGRANIT



Design and planning tips

- Min cabinet size: 42 in (1067 mm)
- Rim thickness: 7/16 in (11 mm)

Specifications:

Includes bridge cutting board, accessories holder and large colander

Installation on a wooden frame, no clips required.
IMPORTANT: Specific cutout dimensions are required for proper accessories usage. Please refer to the installation instructions. Reversible sink.

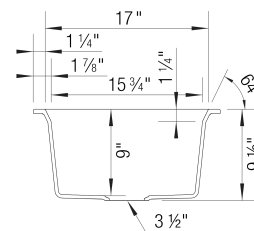
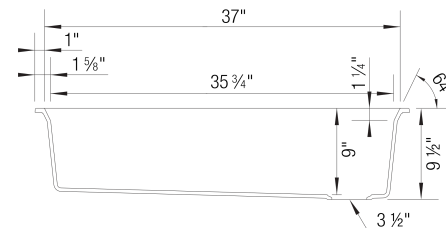

Included Accessories

INTEOS Cutting Board	443336
INTEOS Accessory Frame	443337
INTEOS Large Colander	443338

Optional Accessories

INTEOS Grid 39	443346
INTEOS Large Tray	443339
INTEOS Dish Rack	443342
INTEOS Small Colander	443340
INTEOS Small Tray	443341
INTEOS Organizer XL 40	527670
Storage Caddy 20	527667
Storage Caddy 40	527668

Warranty

Limited lifetime warranty on all sinks and faucets. One-year warranty on all accessories and soap dispensers.

Code/Standards Compliance

BLANCO sinks and faucets are third-party tested and certified to CSA, cUPC, ANSI/ASME, IAPMO and NSF standards and listed by applicable certification bodies. For more information on individual product listings, contact our office or listing organization.



Need support? Learn more by watching our sink & faucet How-to videos:

<https://www.blanco.com/ca-en/support/how-to-videos/how-to-videos-for-sinks/>



BLANCO Canada Inc
100 Corporation Drive
Brampton ON L6S 6B5

Tel & Fax
Tel: 905-494-2400 Toll free: 1-877-425-2626
Fax: 905-494-2425 Toll free: 1-877-825-2626

While BLANCO strives to provide accurate information, all images and dimensions in this document are intended for reference only and are subject to change at any time without notice. This document is not intended for use as an installation guide. For technical installation details, refer to installation instructions provided with the product. BLANCO assumes no responsibility for the use of superseded or voided specifications.