

Product information sheet SUBLINE 400-U for Coloured Components

Item no. 527791

Benefits



- Create perfect colour harmony by choosing a Coloured Components InFino set (ordered separately) to match the tap finish
- Our versatile SUBLINE kitchen sink range fits harmoniously into the worktop: great for minimalist kitchens
- Straight-lined design: timelessly elegant

Colours



Available colours:

black
anthracite
rock grey
volcano grey
white
soft white
tartufo
coffee

SILGRANIT white

Planning information

- Cut out radius: 10 mm
- Note: Drainage components must be ordered separately.

Scope of supply

- Fixing kit

Details

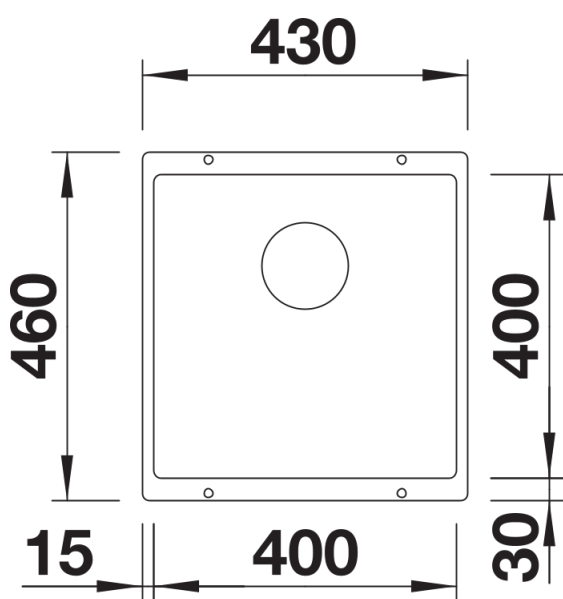

Top view

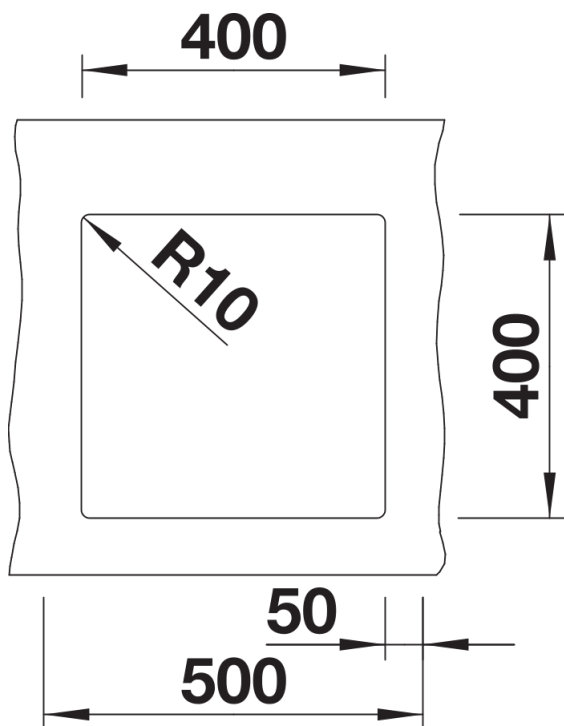

Cut-out

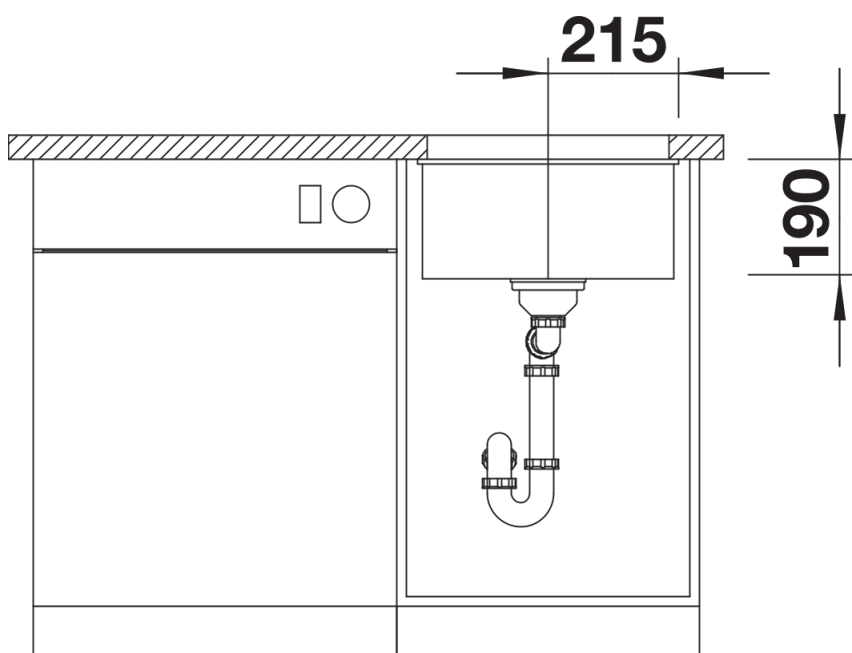

Front view

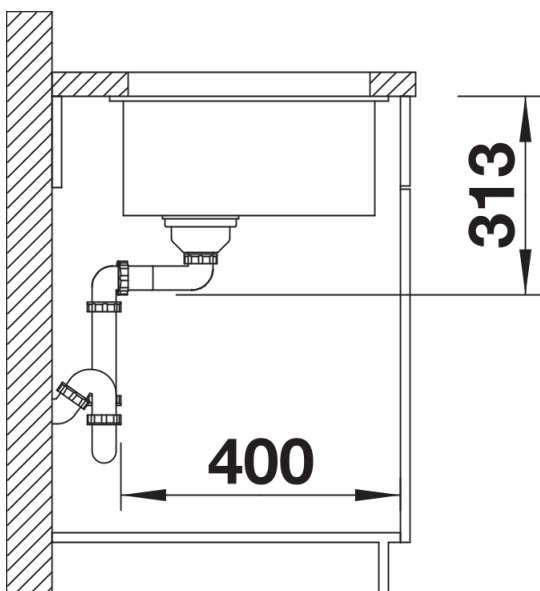

Side view