

## Product information sheet BLANCOCULINA-S II Sensor

Item no. 527462

### Benefits

---



- Iconic mixer tap combining exquisite design with semi-pro functionality
- Manual or hands-free operation with ingenious dual sensor technology integrated in the hose arm and tap body for optimised kitchen workflows
- Wave sensor on the tap body activates hands-free operation
- Hands-free sensor on the spray arm activates automatic operation
- Supplied with electrical plug and integrated battery backup

### Colours

---



Available colours:

PVD steel

PVD PVD steel

## Scope of supply

---

- Electrical connection to 230V
- Battery backup and batteries supplied
- With electronic cartridge and valve box
- Easy and fast professional installation with BLANCO Lock
- Ø 35 mm tap hole required
- Flexible connector pipes, 950 mm long and  $\frac{3}{8}$ " nut
- Requires balanced high pressure supply only, minimum 1.0 bar
- Fit metal stabilising bracket if required, item number 513383

## Details

---

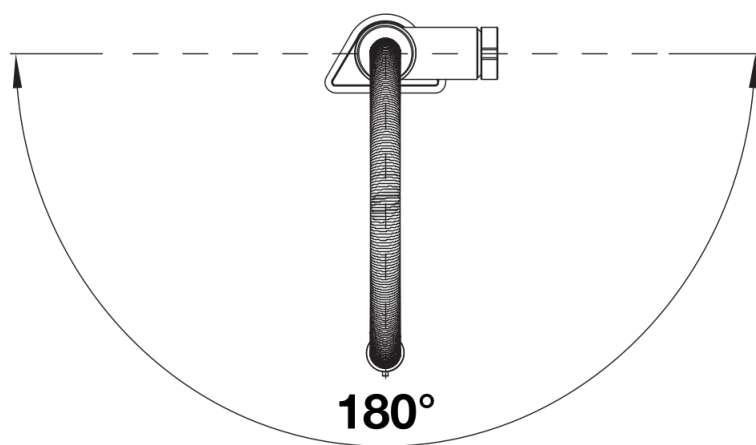

## Swivel range

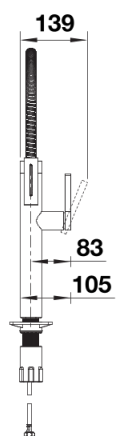

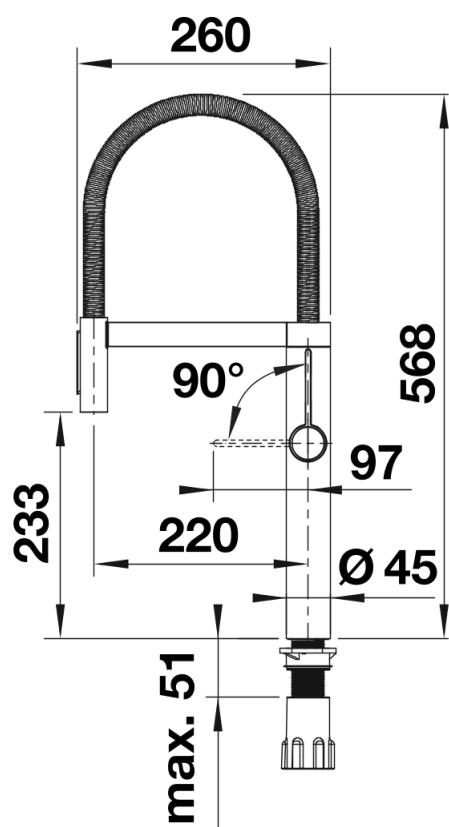

Side view