

Product information sheet LANORA-S

Item no. 523123

Benefits



- High-quality solid stainless steel, brushed finish
- Clear mixer tap design for modern kitchens
- High arched outlet for easy filling of pots and vases
- Stylish L shaped spout

Colours



Available colours:
brushed stainless steel

solid brushed stainless steel

Planning information

- Please note:
High pressure supply only, requires minimum of 1.0 bar pressure (approx 10 metre head)
Height: 295mm
Reach: 220mm
Base: 52mm
Tap hole: ø35mm

Scope of supply

- Ø 35 mm tap hole required
- Flexible connector pipes, 700 mm long and $\frac{3}{8}$ " nut
- Requires balanced high pressure supply only, minimum pressure 1.0 bar
- Fit metal stabilising bracket if required, item number 513383

Details

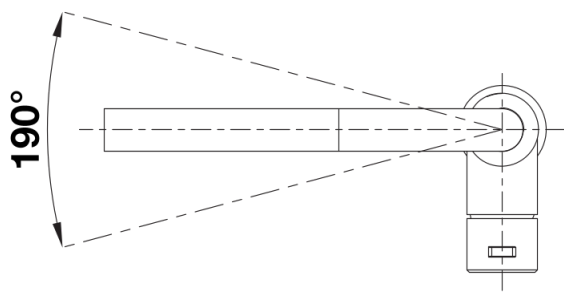

Swivel range

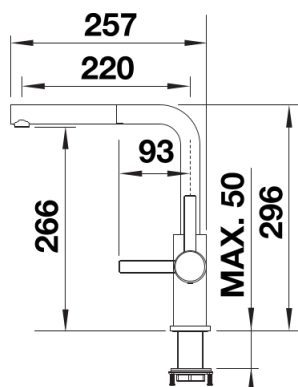
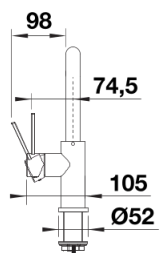

Side view