

## Product information sheet LANORA-S

Item no. 523123

### Benefits

---



- High-quality solid stainless steel, brushed finish
- Clear mixer tap design for modern kitchens
- High arched outlet for easy filling of pots and vases
- Stylish L shaped spout

### Colours

---



Available colours:  
brushed stainless steel

solid brushed stainless steel

## Planning information

---

- Please note:
- High pressure supply only, requires minimum of 1.0 bar pressure (approx 10 metre head)
- Height: 295mm
- Reach: 220mm
- Base: 52mm
- Tap hole: ø35mm

## Scope of supply

---

- Single lever monobloc mixer tap with pull-out metal tap head on a flexi-hose
- Ceramic disc control
- $\frac{3}{8}$ " flexible connector pipes, 450mm long for easier installation
- Patented jet regulator for markedly reduced scaling
- Requires balanced high pressure supply only, minimum 1.0 bar
- Fit metal stabilising bracket if required, item No. 513383

## Details

---

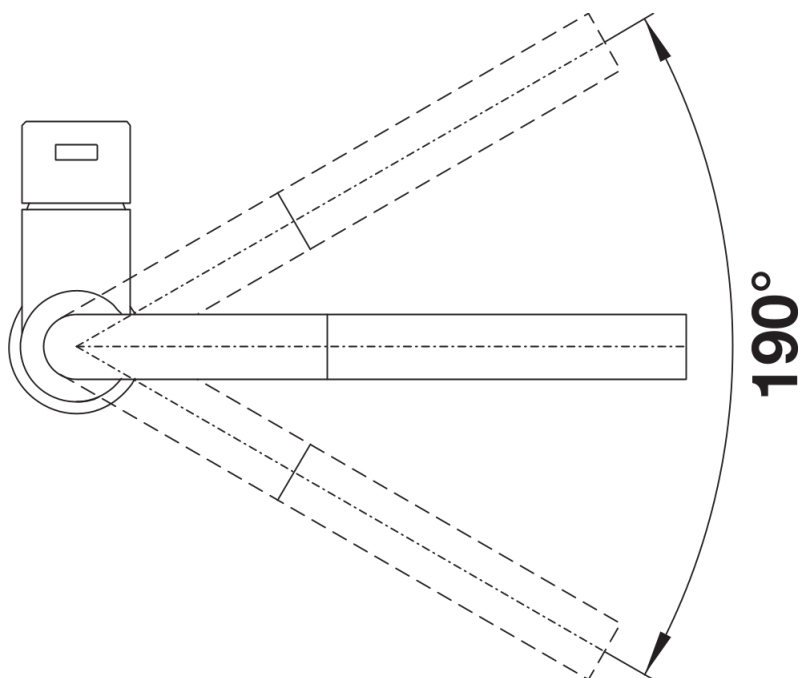

Swivel range

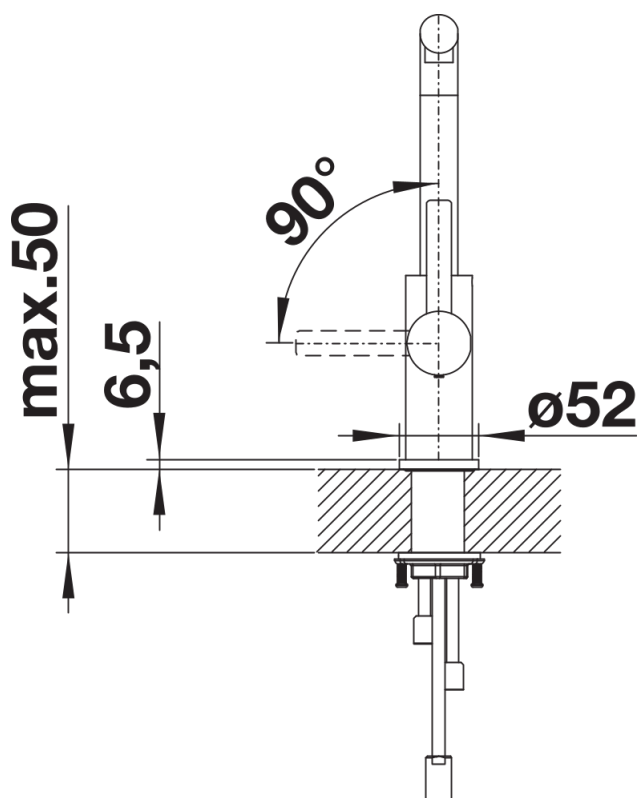

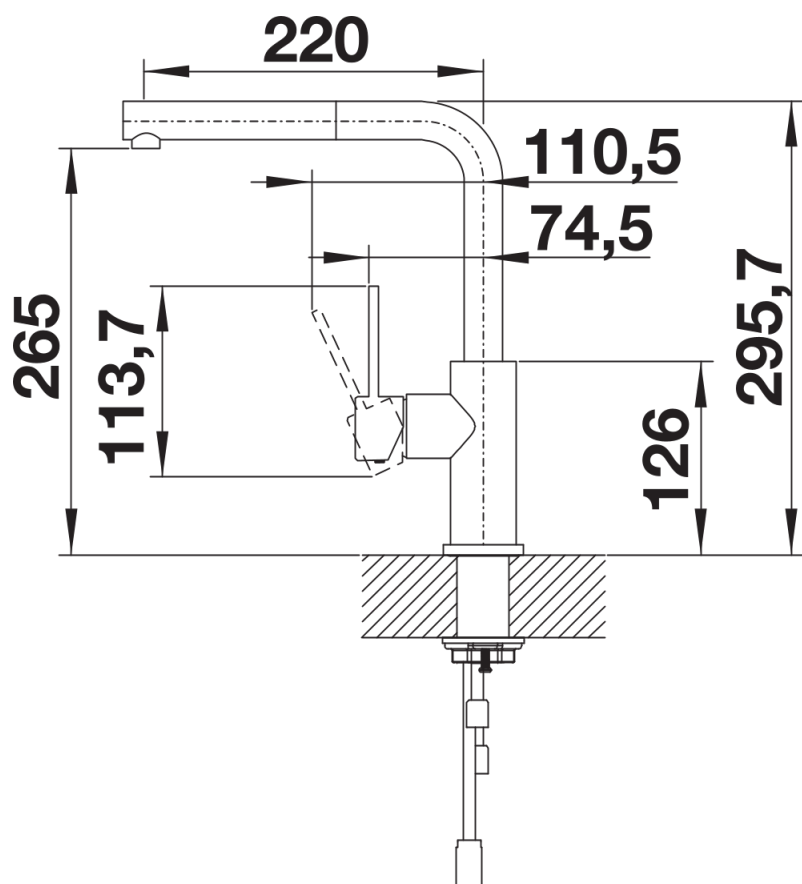

Side view