

## Product information sheet SONA 6 S

Item no. 519853

### Benefits

---



- Prominent grooved tap ledge and drainer area with a curved sink design
- Sizeable main sink and smaller additional sink for easy food prep
- Generous tap ledge to reduce water splashes on the worktop
- Rounded internal corners for easy cleaning
- Stainless steel basket strainer catches food debris helping prevent drain blockages
- Reversible installation

## Colours

---



SILGRANIT rock grey

Available colours:

black  
anthracite  
rock grey  
volcano grey  
white  
soft white  
tartufo  
coffee

## Planning information

---

- Cut out: 980 x 480 x R15<br>Universal handing

## Scope of supply

---

- Waste fitting with space-saving pipe
- 2 x 3½" basket strainers
- ½ bowl non close basket strainer

## Details

---

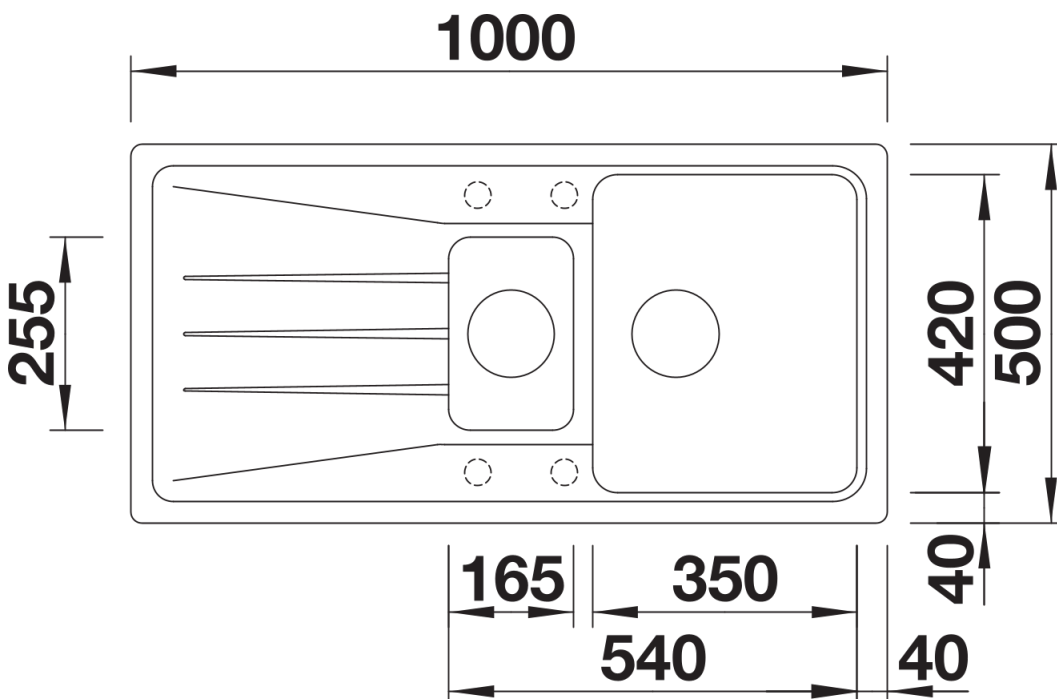

Top view

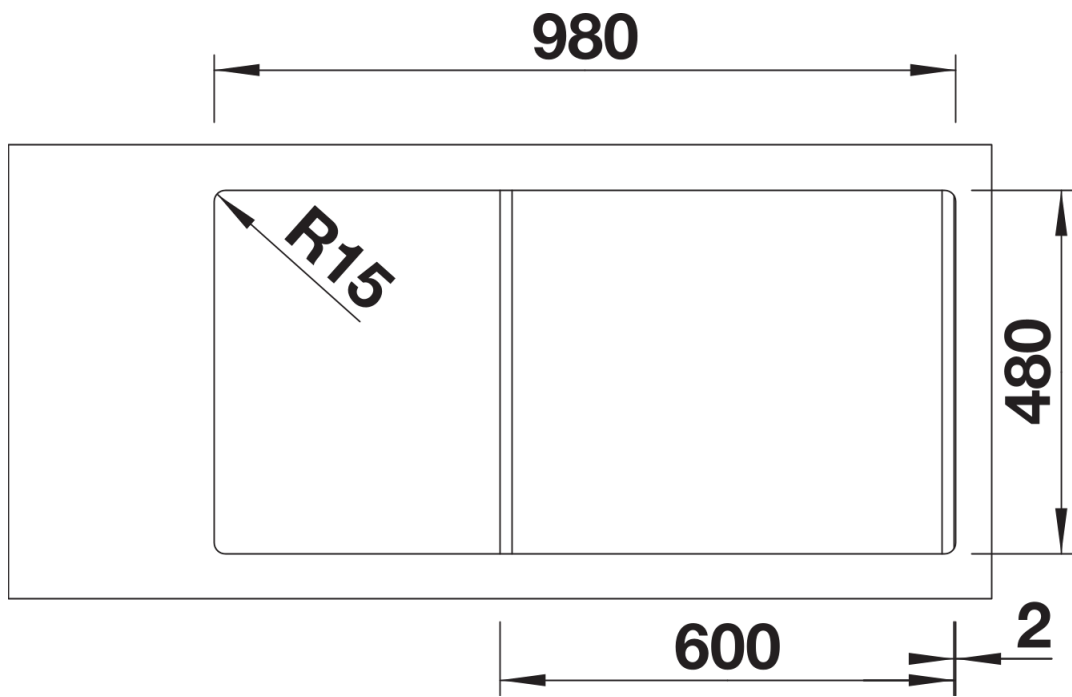

Cut-out

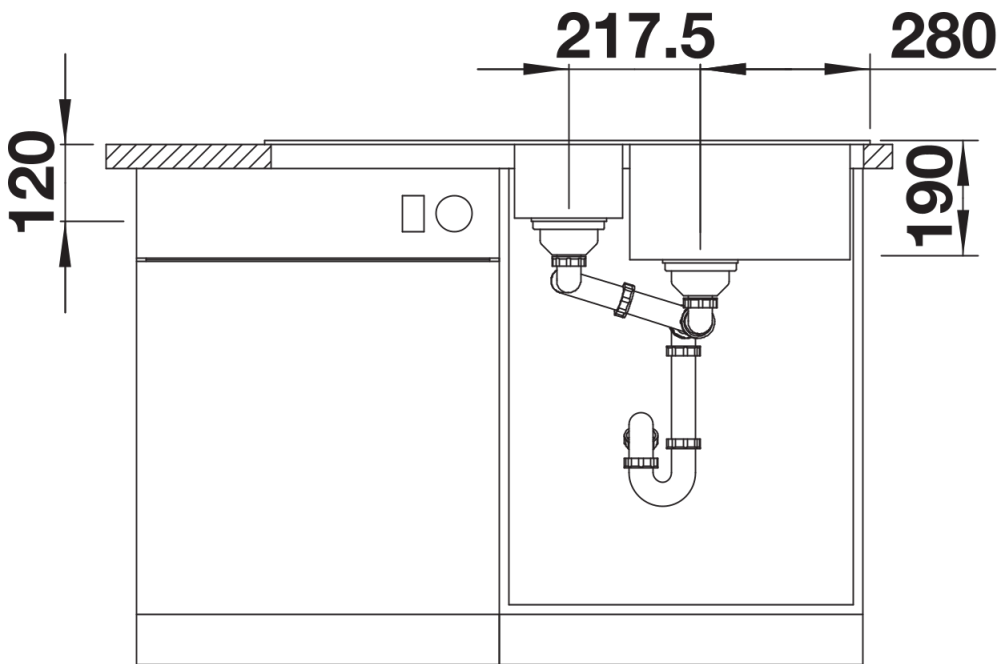

Front view

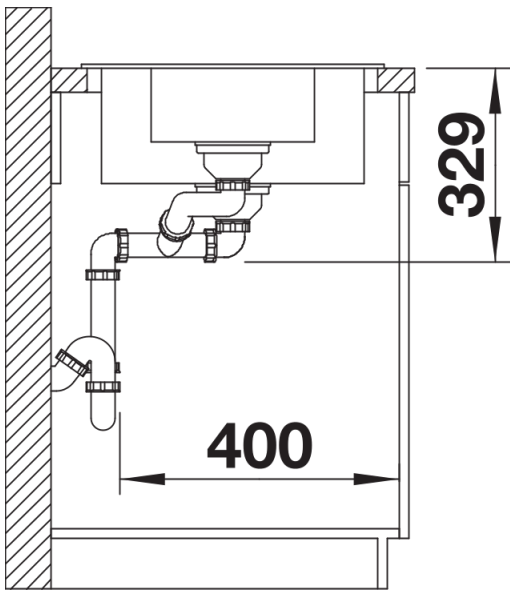

Side view