

## Product information sheet SONA 6 S

Item no. 525975

### Benefits

---



- Striking grooved tap ledge and drainer area with curved bowl design
- Spacious main bowl and large additional bowl handle the deepest pots and pans
- Generous tap ledge to reduce water splashes on the worktop
- Rounded internal corners for easy cleaning
- Stainless steel basket strainer keeps the drain free from food debris and blockages
- Reversible installation

### Colours

---



SILGRANIT black

Available colours:

black  
anthracite  
rock grey  
volcano grey  
white  
soft white  
tartufo  
coffee

## Planning information

---

- Cut out: 980 x 480 x R15<br>Universal handing

## Scope of supply

---

Waste fitting with space-saving pipe, two 3½" basket strainers, ½ bowl non close basket strainer

## Details

---

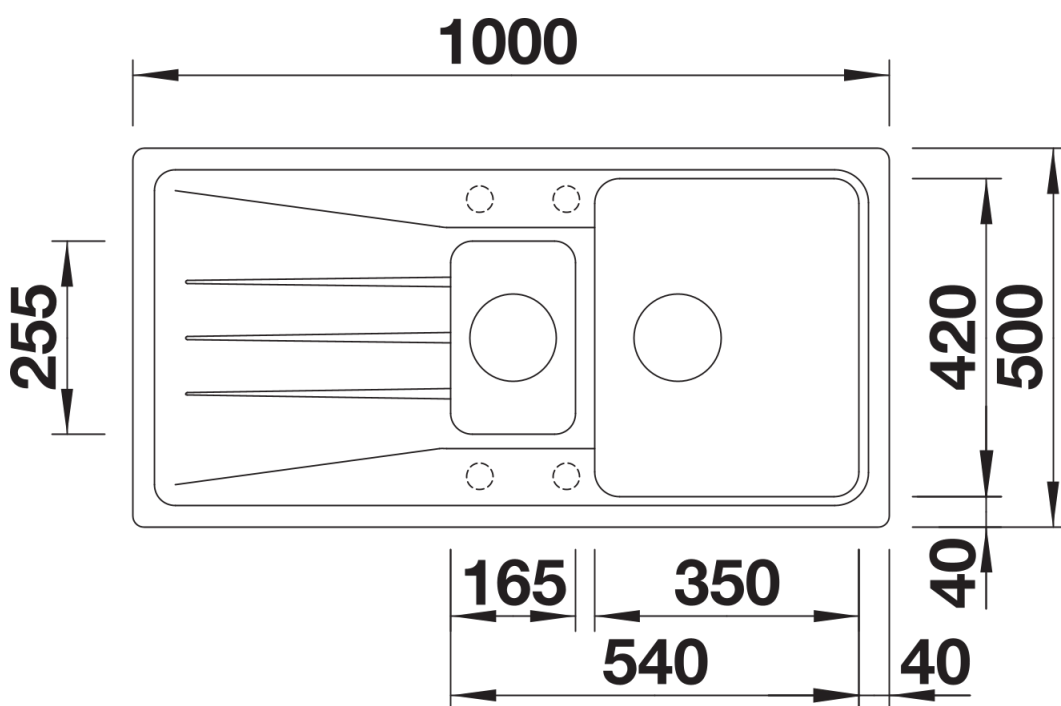

Top view

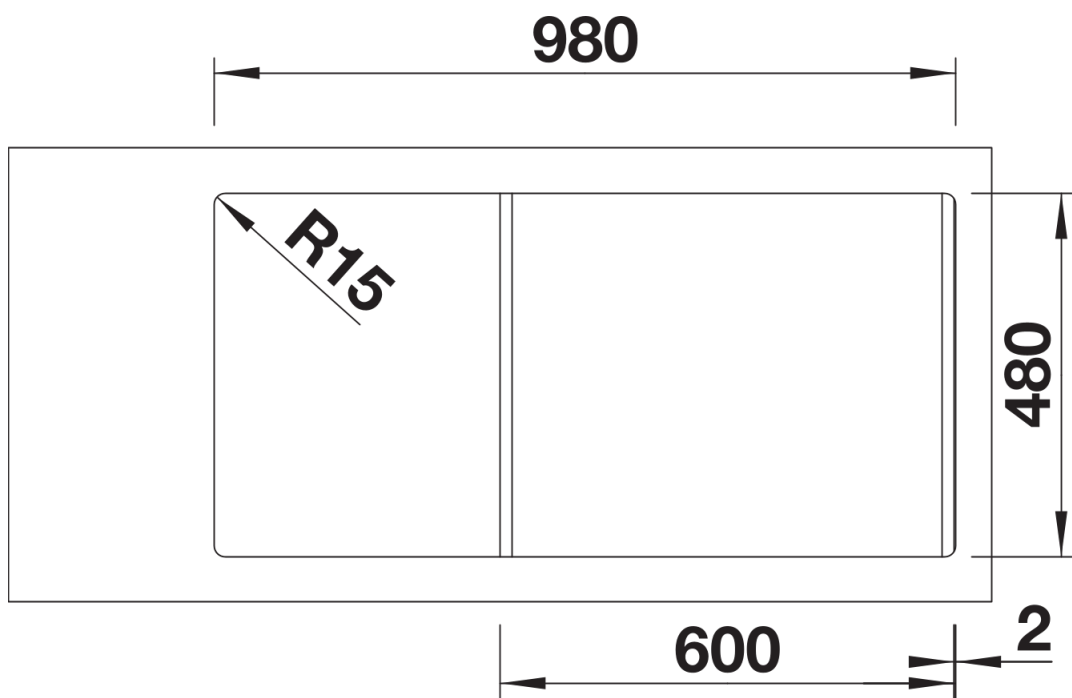

Cut-out

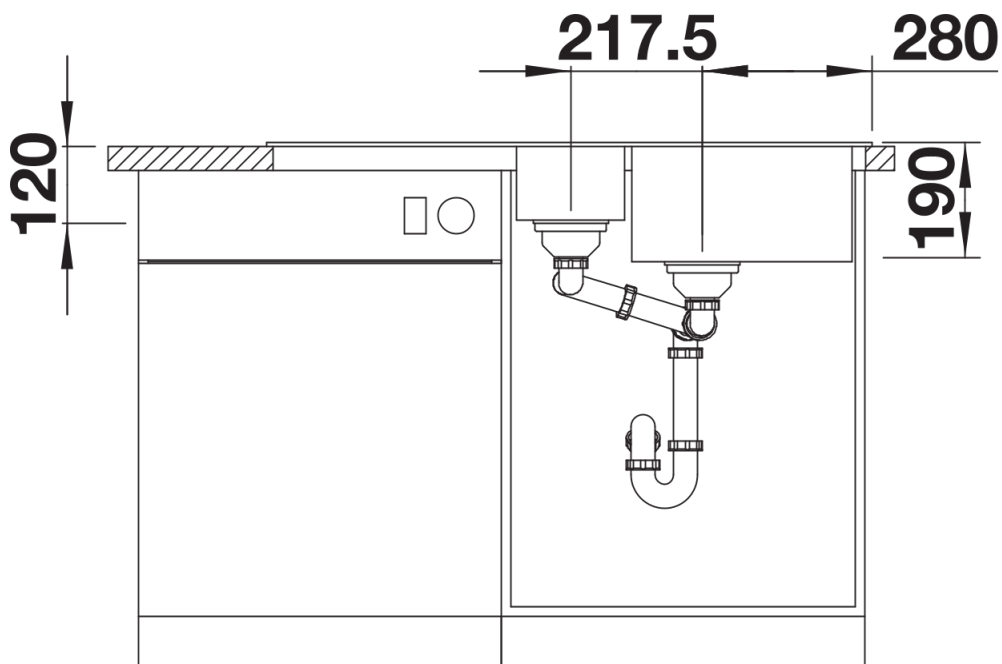

Front view

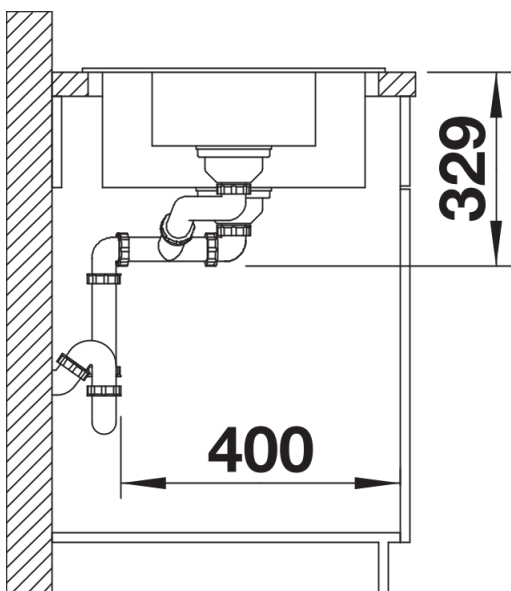

Side view