

## Product information sheet VONDA

Item no. 518434

### Benefits

---



- Ergonomic control lever for front control
- Consistently straight-lined design
- Spout with black accents and a pleasant soft grip surface
- High arc spout for easy filling of pans and vases
- Highly recommended for undermount bowls

### Colours

---

Available colours:  
chrome



galvanic chrome

## Planning information

---

- Cut out size: 700 x 400 x R10  
Cut out information supplied with bowls.  
Cut out CNC files also available on [www.blanco.co.uk](http://www.blanco.co.uk) for download.

## Scope of supply

---

- Ø 35 mm tap hole required
- Flexible connector pipes, 950 mm long and  $\frac{3}{8}$ " nut
- Requires balanced high pressure supply only, minimum 1.0 bar
- Fit metal stabilising bracket if required, item number 513383

## Details

---

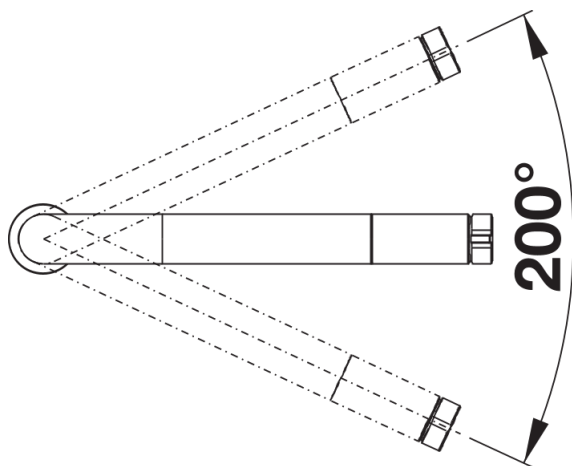

Swivel range

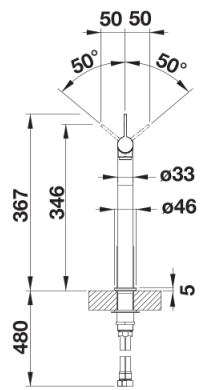

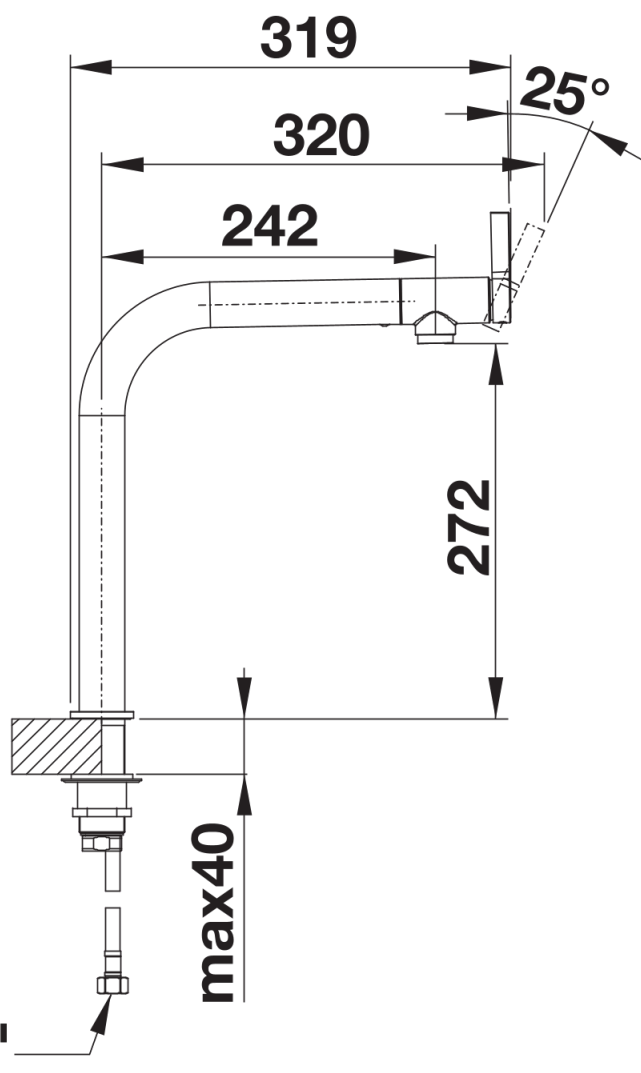

Side view