

Product information sheet SUBLINE 350/350-U

Item no. 523578

Benefits



- Our versatile SUBLINE kitchen sink range fits harmoniously into the worktop: great for minimalist kitchens
- Straight-lined design: timelessly elegant
- Two bowls soak baking trays in one sink and leave the other for separate tasks
- Elegant InFino strainer for swift water drainage

Colours



Available colours:

black
anthracite
rock grey
volcano grey
white
soft white
tartufo
coffee

SILGRANIT white

Planning information

- Cut out size: 725 x 400 x R10

Scope of supply

- Waste fitting with space-saving pipe
- two 3 ½" InFino basket strainer

Details

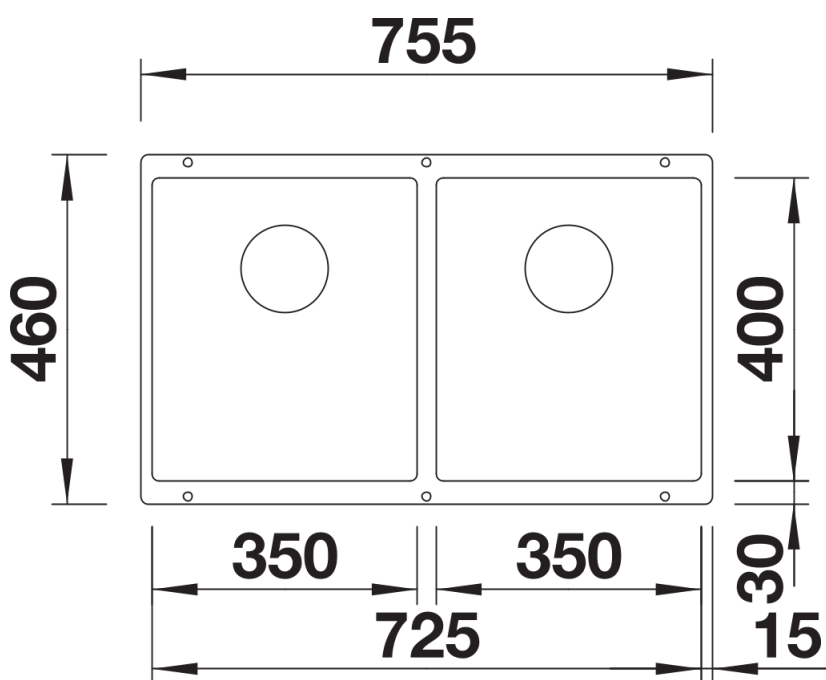

Top view

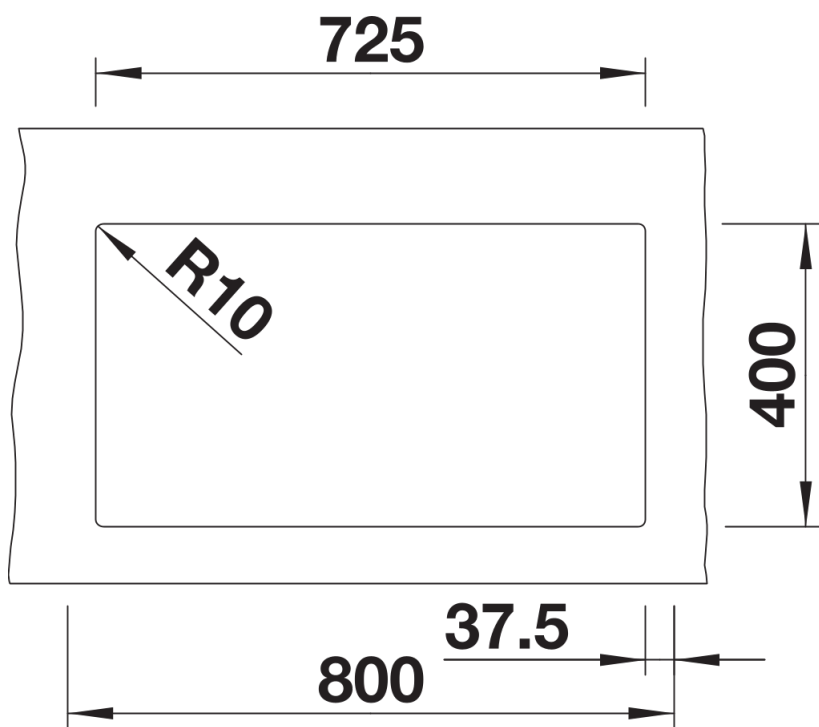

Cut-out

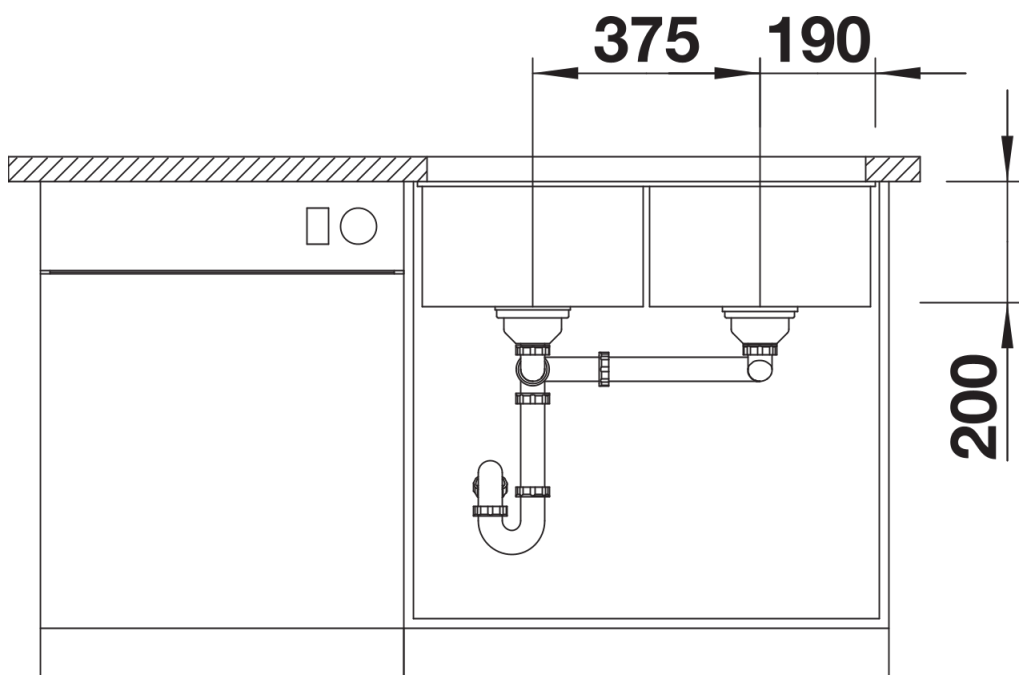

Front view

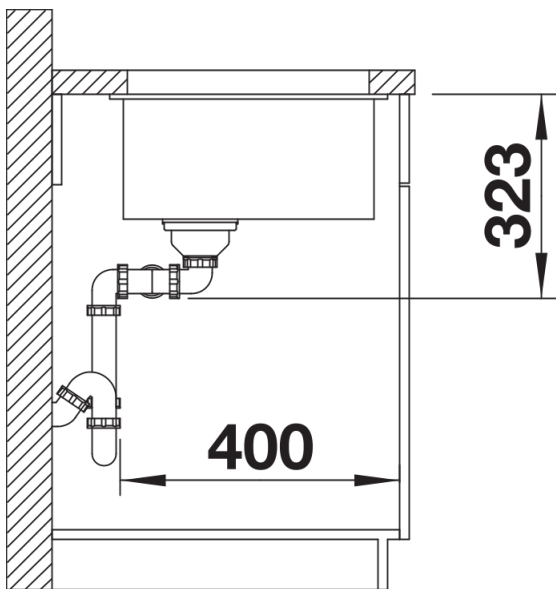

Side view