

Product information sheet ELON 45 S

Item no. 525879

Benefits



- Compact single-bowl sink for small kitchens
- Large bowl size for 45 cm cabinet
- Clever extendable drainer thanks to the movable stainless steel grid
- Modern undulating design of sink and accessories match each other perfectly
- Multifunctional stainless steel drainer grid included in the delivery
- High-quality features with InFino drain system with remote control - elegantly integrated and easy-care
- Tap ledge on side, also convenient for window installation
- Can be installed reversibly

Colours



Available colours:

black
anthracite
rock grey
volcano grey
white
soft white
tartufo
coffee

SILGRANIT black

Scope of supply

- stainless steel drainer grid
- waste kit with space-saving pipe
- 3 ½" InFino basket strainer with drain remote control (rotary switch)

229234 - Drainer grid

Details

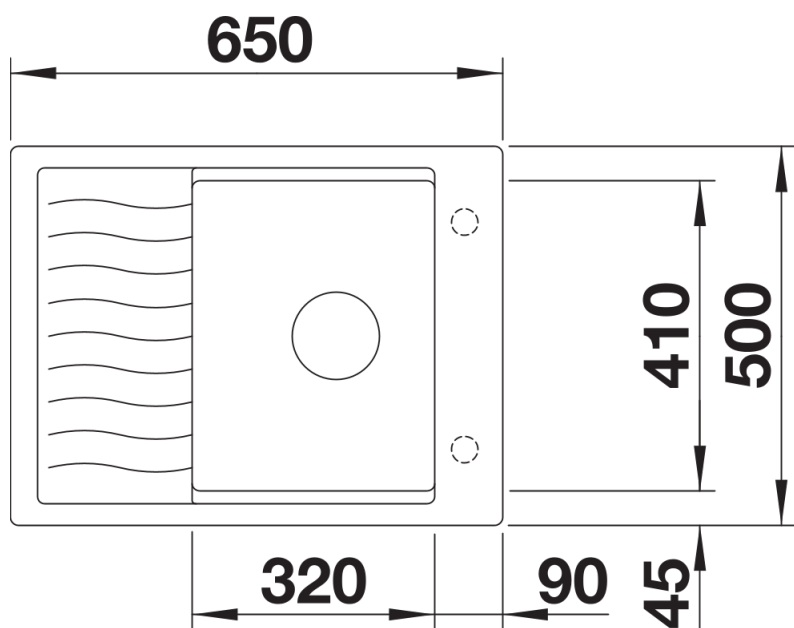

Top view

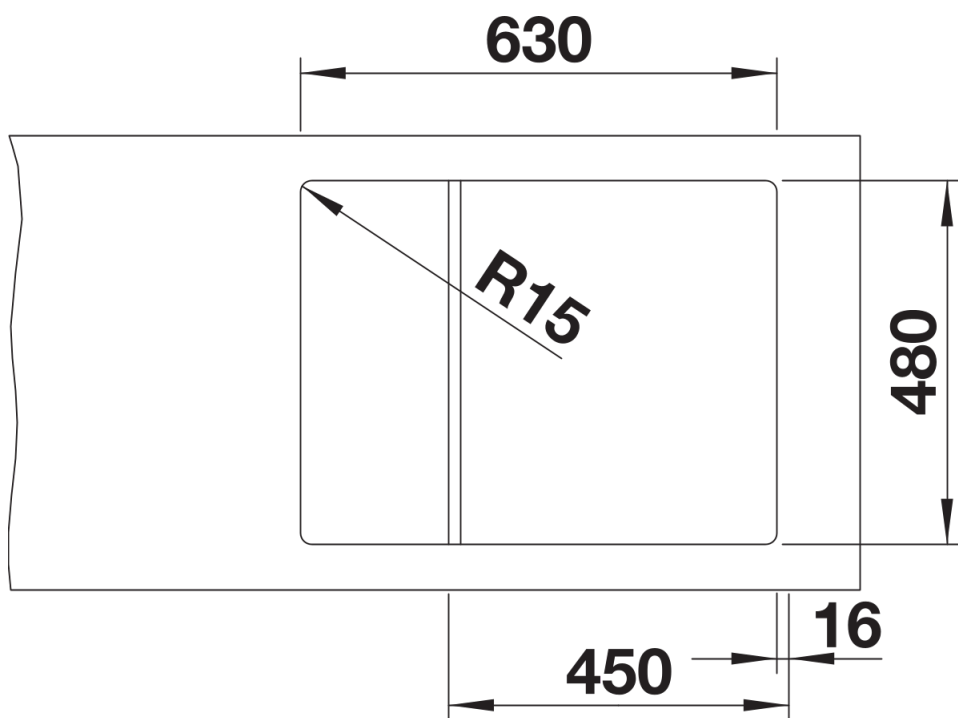

Cut-out

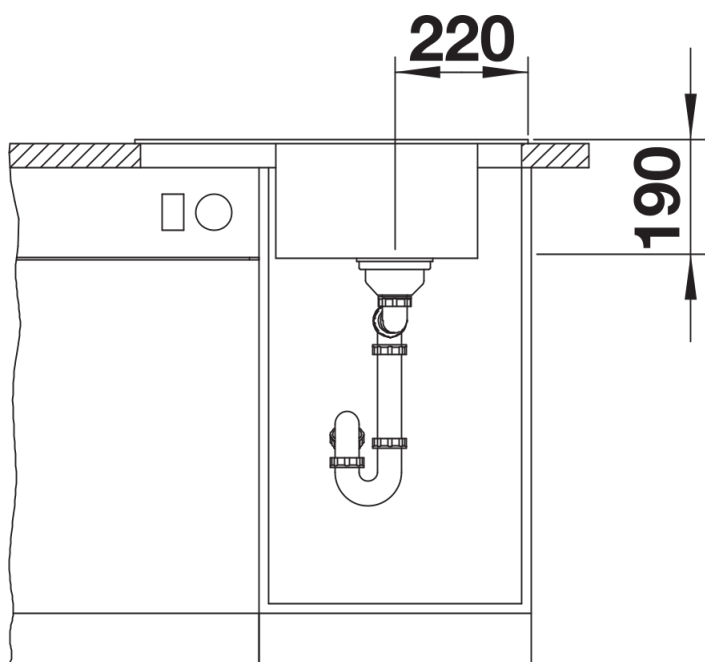

Front view

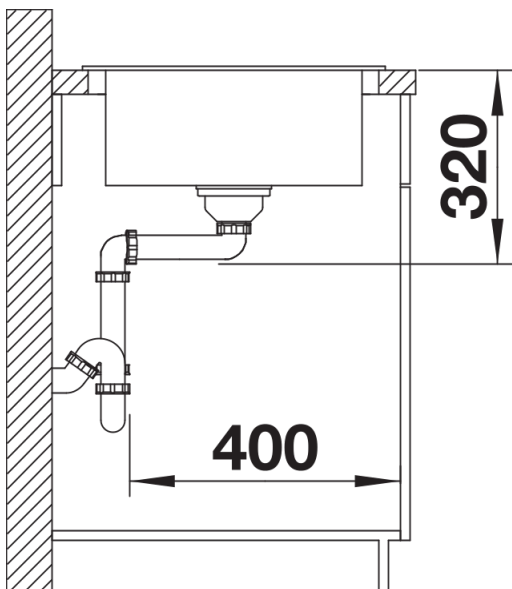

Side view