

Product information sheet MILA-S

Item no. 526660

Benefits



- Slender body with a straight-lined spout
- Black matt surface finish to precisely match the surroundings
- With extendable pull-out hose
- For the easy filling of tall pots and vases
- Enlarged working radius thanks to the 360° swivel spout

Colours



Available colours:

black matt

Special colours black matt

Scope of supply

- Single-lever mixer tap
- Ceramic disk cartridge
- Flexible connector pipes, 350 mm long and $\frac{3}{8}$ " nut for particularly easy installation
- Nylon-sheathed spray hose
- Ø 35 mm tap hole required
- Stabilisation plate to increase the stability of the tap when fitted in stainless steel sinks
- With non-return valve and thus guaranteed against reflux in accordance with EN 1717
- LGA approved
- DVGW approved

Details

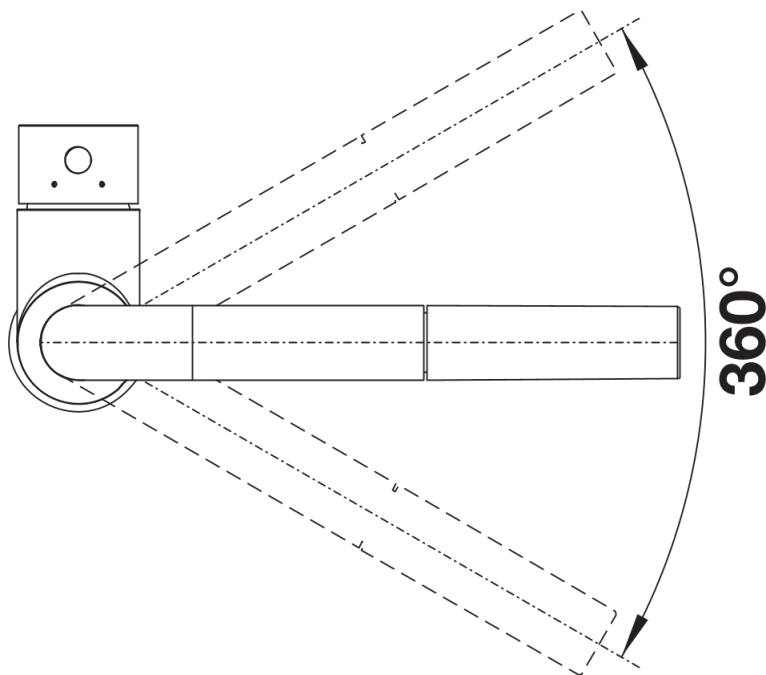

Swivel range

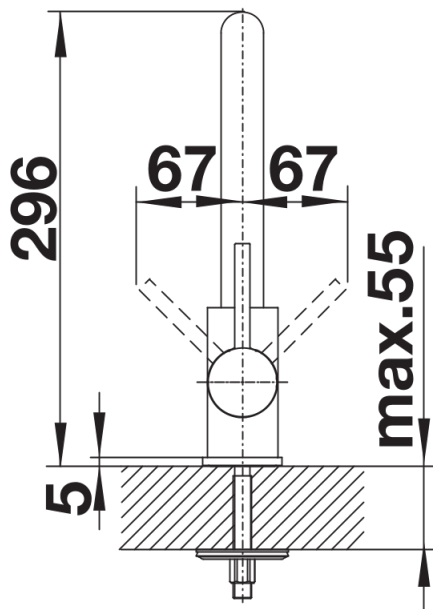

Side view hand gear 2D

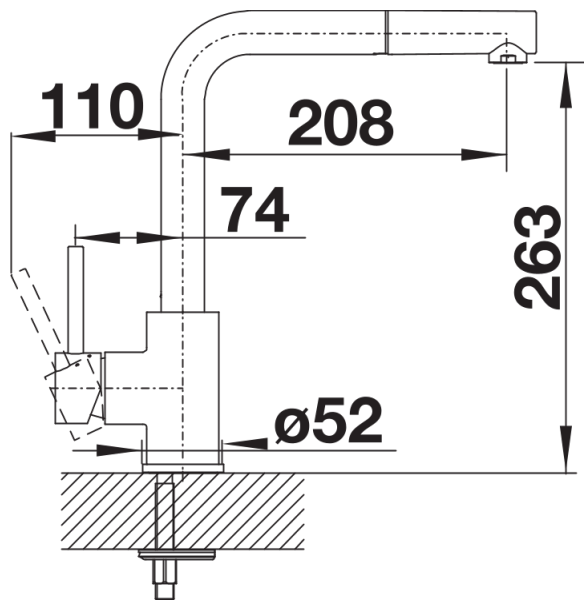

Side view