

Product information sheet TRIMA Filter

Item no. 520840

Benefits



- Comfortable 3 in 1 mixer tap with cold and warm water lever on the right, filtered water lever on the left
- Ergonomically shaped control elements with clear identification of functions
- Separate water circuit with extra spout for filtered water
- 360° swivel spout for greater reach
- Needs to be installed with a water filter system

Colours



Available colours:

chrome

galvanic chrome

Scope of supply

- 360° swivel spout for greater reach
- Ø 35 mm tap hole required
- Valve and cartridge with ceramic seals
- Flexible connection pipes with a length of 450 mm and $\frac{3}{8}$ " swivel nut for particularly easy and secure installation
- Patented jet regulator for markedly reduced scaling
- Stabilisation plate to increase the stability of the tap when fitting in stainless steel sinks
- LGA approved

Filter system not included.

Details

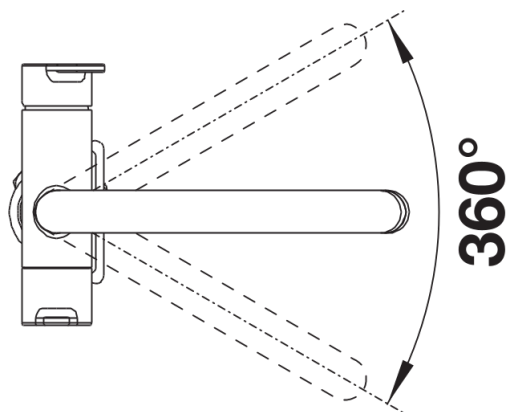

Swivel range

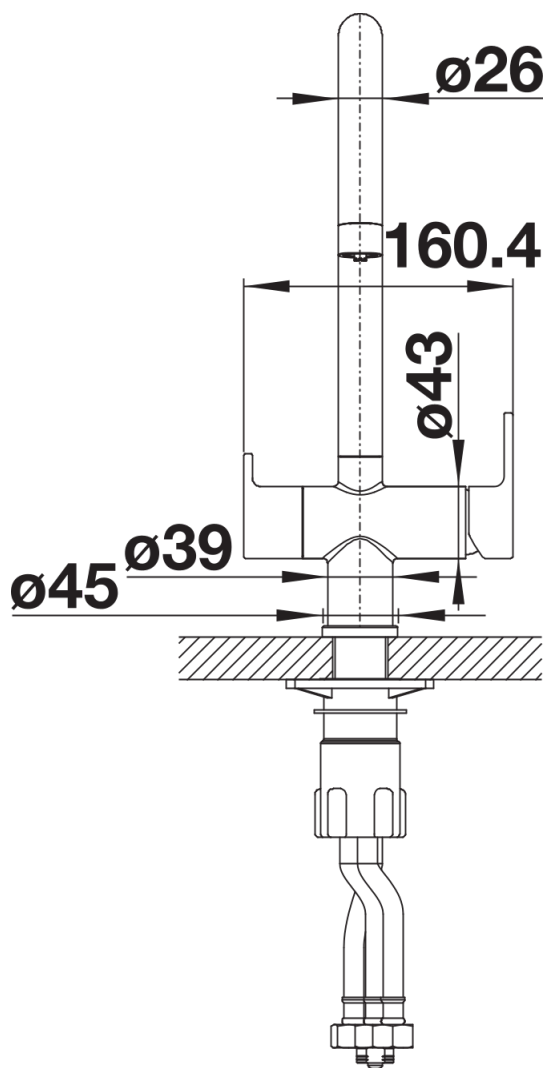

Side view hand gear 2D

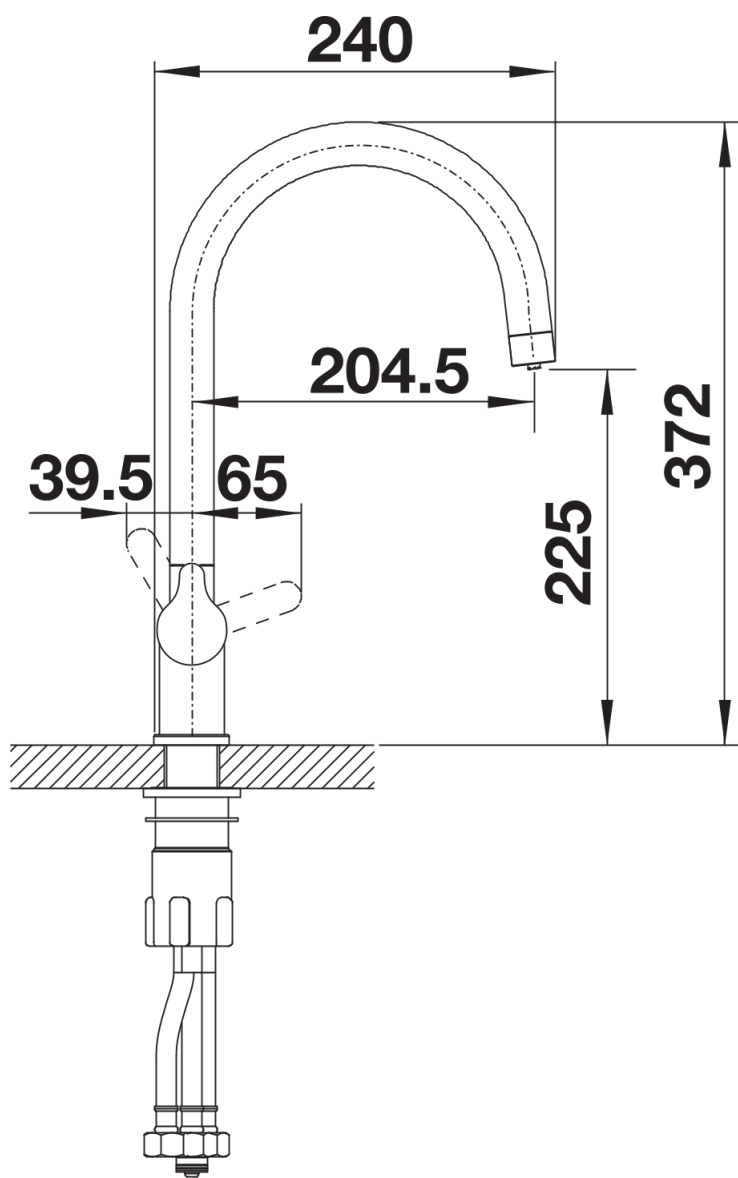

Side view