



Sink Specifications

Color	SKU
White	523026

Design and Planning Tips

- Min cabinet size: 39 in
- Apron front height: 10 in (254 mm)

What is included:

Beechwood cutting board included, Installation instructions, Limited Lifetime Warranty

A custom sink base and support system are required for installation of this sink.

The cabinet area beneath the sink **MUST** be reinforced to provide sufficient support.

Wood or metal support frame for the sink must support 400 lbs

To protect from damage, sink must ship on a pallet

Reversible

Codes & Standards

ASME A112.19.2-2013/ CSA B45.1-13

Optional Accessories

3-in-1 Basket Strainer	441231
Sink Grid	234691
Dish Rack	234699
CapFlow Strainer Cover	517666
Universal Bag XL 40	527669

PROFINA

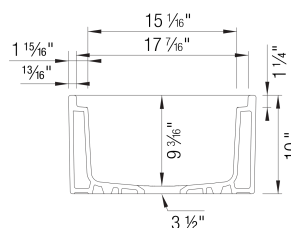
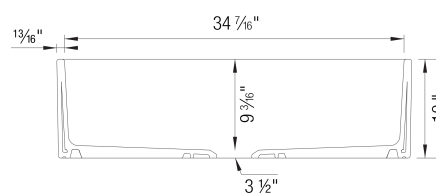
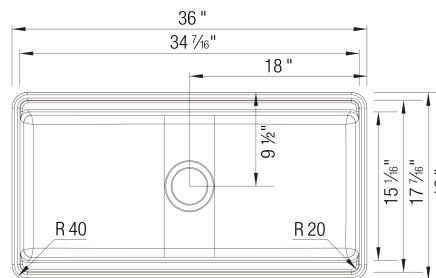

Warranty

BLANCO offers a limited lifetime warranty on all sinks and faucets, as well as a one-year warranty on all custom accessories.

Code/Standards Compliance

BLANCO sinks and faucets are third-party tested and certified to standards and listed by applicable certification bodies. For more information on individual product listings, contact our office or listing organization.



View our how-to videos to learn more about installing and caring for BLANCO products:
<https://www.blanco.com/us-en/service/how-to-videos/how-to-videos-for-sinks/>

Questions? Contact us today



BLANCO America, Inc.
110 Mount Holly By-Pass
Lumberton, NJ 08048

Phone & Fax
Phone: 888-668-6201
Fax: 609-668-6211

While BLANCO endeavors to provide accurate information, all dimensions are nominal, cannot be guaranteed, and are subject to change or cancellation. BLANCO assumes no responsibility for use of superseded or voided specifications.